

Typ 20 Wagentürscharniere Stahl-roh, ungelocht, mit Halbrundkopfstift
 Stahl-roh und DU-Buchsen

1

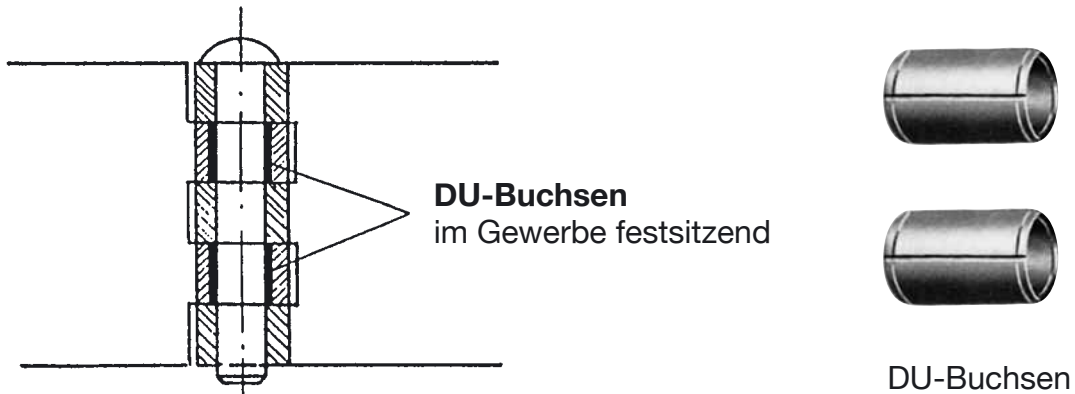

DU-Lagerwerkstoffe Trocken-Gleitmaterial mit verzinnem Stahlrücken, wartungsfrei



204 ... mit Halbrundkopfstift Stahl-roh und DU-Buchsen

| Artikel-Nr.: | A | B1 | B2 | C | D | Gewerbe- teilung |
|--------------|----|-----|-----|----|----|---------------------|
| | mm | mm | mm | mm | mm | |
| ... 30 51 | 30 | 30 | 30 | 5 | 6 | 5 |
| ... 30 52 | 30 | 60 | 60 | 5 | 6 | 5 |
| ... 30 53 | 30 | 80 | 80 | 5 | 6 | 5 |
| ... 30 54 | 30 | 100 | 100 | 5 | 6 | 5 |
| ... 40 51 | 40 | 30 | 30 | 5 | 6 | 5 |
| ... 40 52 | 40 | 60 | 60 | 5 | 6 | 5 |
| ... 40 53 | 40 | 80 | 80 | 5 | 6 | 5 |
| ... 40 54 | 40 | 100 | 100 | 5 | 6 | 5 |
| ... 40 55 | 40 | 120 | 120 | 5 | 6 | 5 |
| | | | | | | |
| | | | | | | |
| | | | | | | |
| | | | | | | |

DU-Lagerwerkstoffe Trocken-Gleitmaterial mit verzinnem Stahlrücken, wartungsfrei

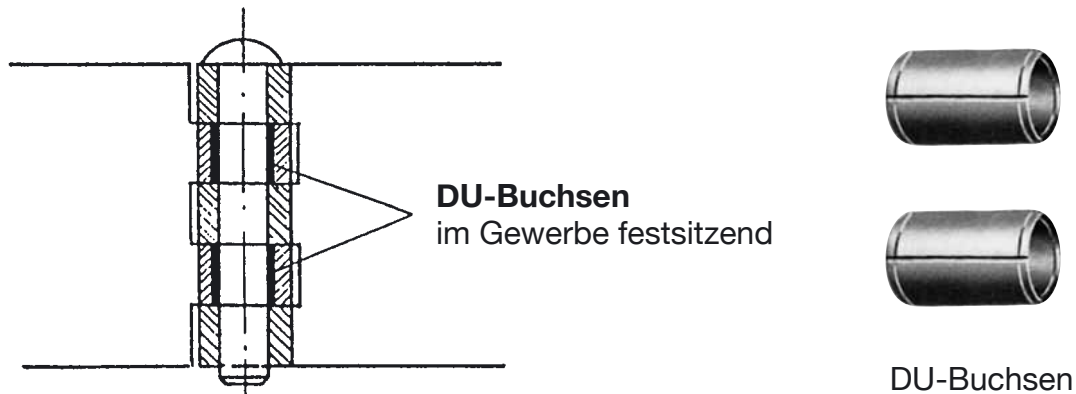

204 ... mit Halbrundkopfstift Stahl-roh und DU-Buchsen

| Artikel-Nr.: | A | B1 | B2 | C | D | Gewerbe- teilung |
|--------------|----|-----|-----|----|----|---------------------|
| | mm | mm | mm | mm | mm | |
| ... 50 51 | 50 | 30 | 30 | 5 | 6 | 5 |
| ... 50 52 | 50 | 60 | 60 | 5 | 6 | 5 |
| ... 50 53 | 50 | 80 | 80 | 5 | 6 | 5 |
| ... 50 54 | 50 | 100 | 100 | 5 | 6 | 5 |
| ... 50 55 | 50 | 120 | 120 | 5 | 6 | 5 |
| ... 60 51 | 60 | 30 | 30 | 5 | 6 | 5 |
| ... 60 52 | 60 | 60 | 60 | 5 | 6 | 5 |
| ... 60 53 | 60 | 80 | 80 | 5 | 6 | 5 |
| ... 60 54 | 60 | 100 | 100 | 5 | 6 | 5 |
| ... 60 55 | 60 | 120 | 120 | 5 | 6 | 5 |
| | | | | | | |
| ... 40 61 | 40 | 80 | 80 | 6 | 8 | 5 |
| | | | | | | |
| | | | | | | |
| | | | | | | |
| ... 50 61 | 50 | 80 | 80 | 6 | 8 | 5 |
| ... 50 62 | 50 | 100 | 100 | 6 | 8 | 5 |
| ... 50 63 | 50 | 120 | 120 | 6 | 8 | 5 |
| ... 60 61 | 60 | 80 | 80 | 6 | 8 | 5 |
| ... 60 62 | 60 | 100 | 100 | 6 | 8 | 5 |
| ... 60 63 | 60 | 120 | 120 | 6 | 8 | 5 |
| ... 60 64 | 60 | 150 | 150 | 6 | 8 | 5 |
| | | | | | | |
| ... 60 71 | 60 | 40 | 40 | 7 | 8 | 5 |
| ... 60 72 | 60 | 80 | 80 | 7 | 8 | 5 |
| ... 60 73 | 60 | 100 | 100 | 7 | 8 | 5 |
| ... 60 74 | 60 | 120 | 120 | 7 | 8 | 5 |
| ... 60 75 | 60 | 150 | 150 | 7 | 8 | 5 |

Typ 20 Wagentürscharniere Stahl-roh, ungelocht,
mit Messing-Halbrundkopfstift und DU-Buchsen

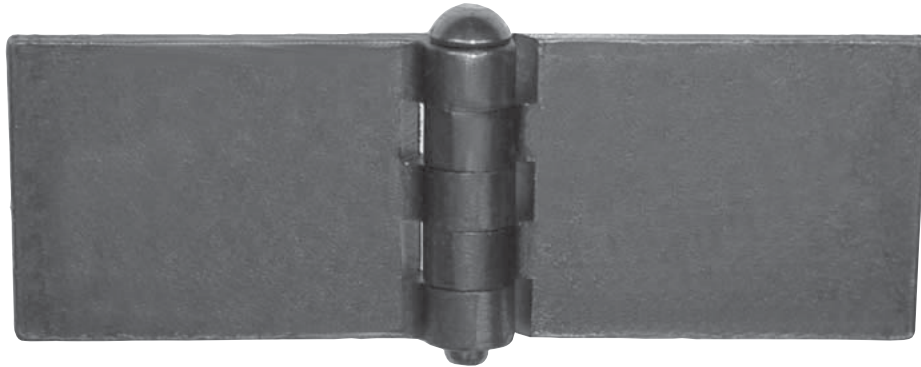

DU-Lagerwerkstoffe Trocken-Gleitmaterial mit verzinnem Stahlrücken, wartungsfrei

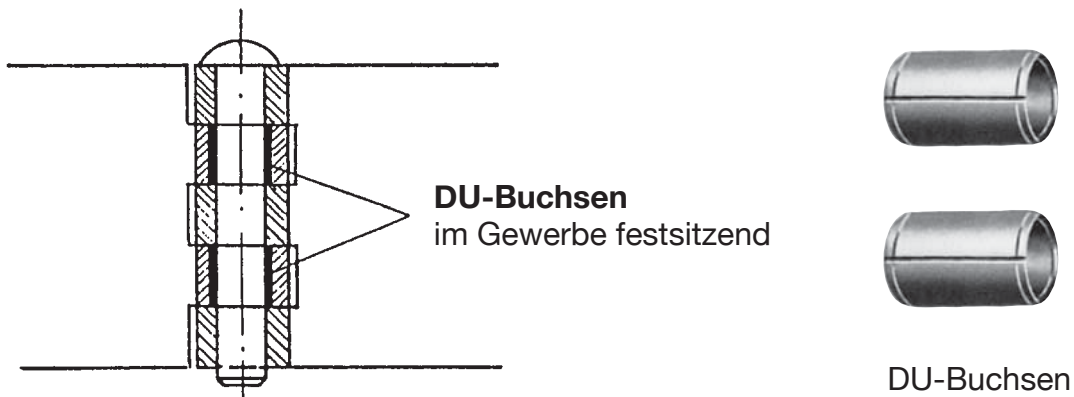

205 ... mit Messing-Halbrundkopfstift und DU-Buchsen

| Artikel-Nr.: | A | B1 | B2 | C | D | Gewerbe- teilung |
|--------------|----|-----|-----|----|----|---------------------|
| | mm | mm | mm | mm | mm | |
| ... 30 51 | 30 | 30 | 30 | 5 | 6 | 5 |
| ... 30 52 | 30 | 60 | 60 | 5 | 6 | 5 |
| ... 30 53 | 30 | 80 | 80 | 5 | 6 | 5 |
| ... 30 54 | 30 | 100 | 100 | 5 | 6 | 5 |
| ... 40 51 | 40 | 30 | 30 | 5 | 6 | 5 |
| ... 40 52 | 40 | 60 | 60 | 5 | 6 | 5 |
| ... 40 53 | 40 | 80 | 80 | 5 | 6 | 5 |
| ... 40 54 | 40 | 100 | 100 | 5 | 6 | 5 |
| ... 40 55 | 40 | 120 | 120 | 5 | 6 | 5 |
| ... 50 51 | 50 | 30 | 30 | 5 | 6 | 5 |
| ... 50 52 | 50 | 60 | 60 | 5 | 6 | 5 |
| ... 50 53 | 50 | 80 | 80 | 5 | 6 | 5 |
| ... 50 54 | 50 | 100 | 100 | 5 | 6 | 5 |
| ... 50 55 | 50 | 120 | 120 | 5 | 6 | 5 |
| ... 60 51 | 60 | 30 | 30 | 5 | 6 | 5 |

DU-Lagerwerkstoffe Trocken-Gleitmaterial mit verzinnem Stahlrücken, wartungsfrei

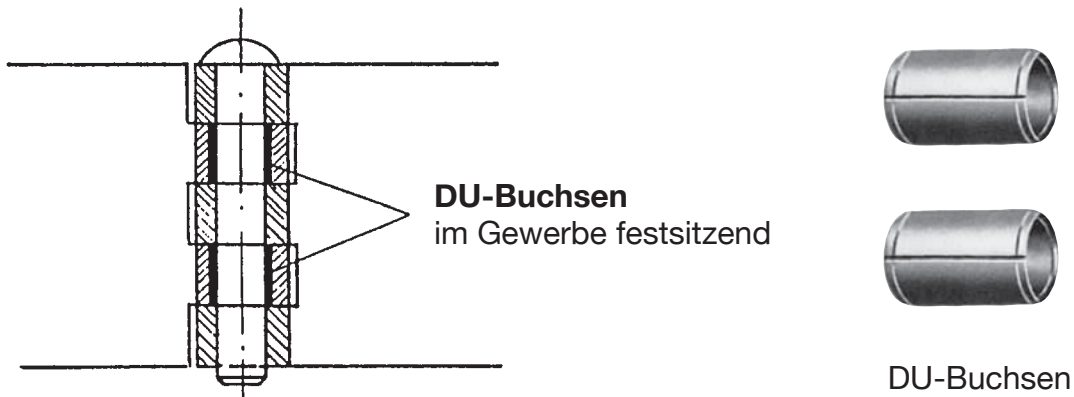

205 ... mit Messing-Halbrundkopfstift und DU-Buchsen

| Artikel-Nr.: | A | B1 | B2 | C | D | Gewerbe- teilung |
|--------------|----|-----|-----|----|----|---------------------|
| | mm | mm | mm | mm | mm | |
| ... 60 52 | 60 | 60 | 60 | 5 | 6 | 5 |
| ... 60 53 | 60 | 80 | 80 | 5 | 6 | 5 |
| ... 60 54 | 60 | 100 | 100 | 5 | 6 | 5 |
| ... 60 55 | 60 | 120 | 120 | 5 | 6 | 5 |
| ... | | | | | | |
| ... 50 61 | 50 | 80 | 80 | 6 | 8 | 5 |
| ... 50 62 | 50 | 100 | 100 | 6 | 8 | 5 |
| ... 50 63 | 50 | 120 | 120 | 6 | 8 | 5 |
| ... 60 61 | 60 | 80 | 80 | 6 | 8 | 5 |
| ... 60 62 | 60 | 100 | 100 | 6 | 8 | 5 |
| ... 60 63 | 60 | 120 | 120 | 6 | 8 | 5 |
| ... 60 64 | 60 | 150 | 150 | 6 | 8 | 5 |
| ... | | | | | | |
| ... 60 71 | 60 | 40 | 40 | 7 | 8 | 5 |
| ... 60 72 | 60 | 80 | 80 | 7 | 8 | 5 |
| ... 60 73 | 60 | 100 | 100 | 7 | 8 | 5 |
| ... 60 74 | 60 | 120 | 120 | 7 | 8 | 5 |
| ... 60 75 | 60 | 150 | 150 | 7 | 8 | 5 |